

Specifications

Current Spec.

16A

32A

Electrical Requirement

Working Voltage: 250V AC/440V AC (single-phase / three-phase)

Insulation Resistance: > 5MΩ (DC500V, 1min)

Terminal temperature rise: < 50K

Breakdown voltage: 2000V

Vibration resistance: in line with the JDQ53.36.1.1-53.36.1.2 requirements
Contact resistance: 0.5mΩ Max

Mechanical Requirement

Mechanical Life : No Load Plug > 10000 cycles

Pull out Force after locking : $F \geq 200N$

Coupling Plug Force : $F < 100N$

Connector Spec.

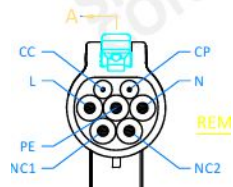

Appearance & Characteristics

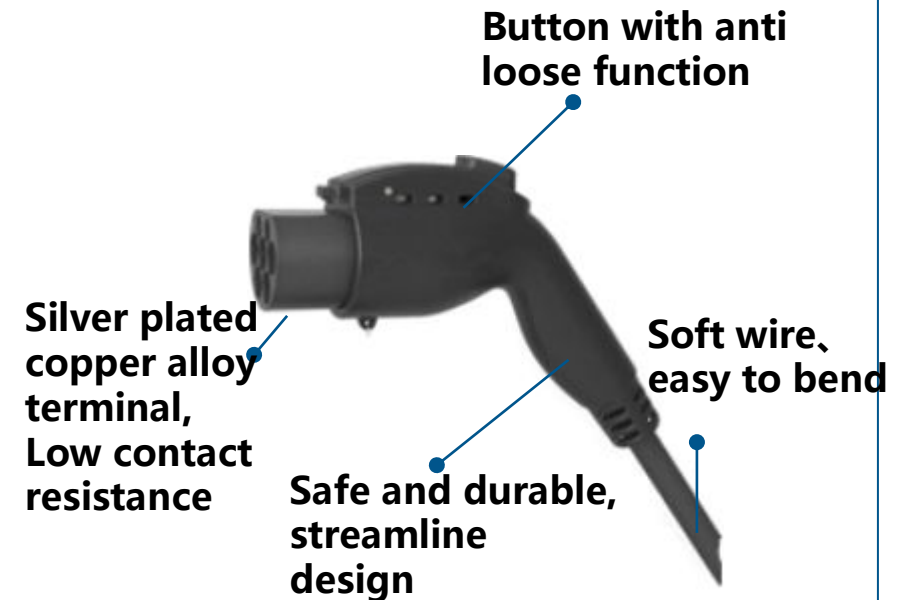



Features & Advantages

Connector size and product performance: fully meet the requirements of new national standard GB/T 20234 ;

Protection: overall protection & Core contact protection, protection class IP67, higher than the GB standard IP54;

Coupler: TPE rubber integral forming . Moderate size, streamline design, safe and comfortable using;

Connector: SINBON self innovated design, greatly reduces the coupling force;

Contact terminal: silver plated copper alloy, effectively reduces contact resistance and prevent temperature rise ;

Button: anti-loose function during charging, easy to pull out after pressing.

Cable: material TPE , with excellent flexibility, soft touch, weathering resistance, fatigue resistance and temperature resistance.

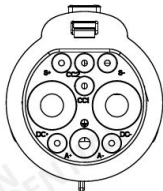
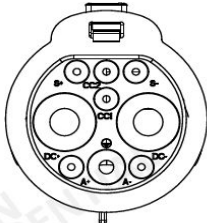
Specifications		
Current Spec.	75A	125A
Electrical Requirement	Working voltage : 400V/750 DC	
	Insulation resistance : > 5MΩ (DC500V , 1min)	
	Terminal Temperature Rise : < 50K	
	Breakdown voltage : 3200V	
	Vibration resistance : in line with the JDQ53.36.1.1-53.36.1.2 requirements	
Mechanical Requirement	Contact resistance : 0.5mΩ Max	
	Mechanical Life : No Load Plug > 10000 cycles	
Connector Spec.	Coupling Plug force : < 140N	
		

Appearance & Characteristics

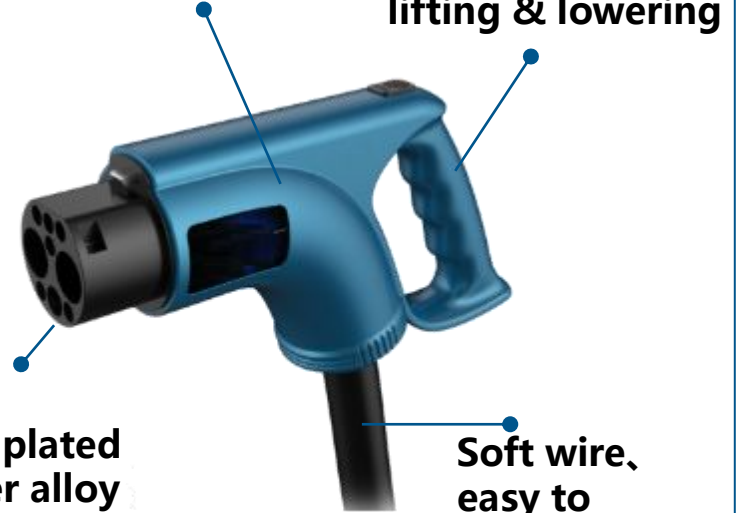

- Streamline design
- Handle, easy for lifting & lowering
- Soft wire, easy to bend
- Silver plated copper alloy terminal, Low contact resistance

Features & Advantages

Connector size and product performance: fully meet the requirements of new national standard [GB/T 20234](#) ; With temperature control and electronic lock it ensures safe use.

Protection: overall protection & Core contact protection, protection class higher than the GB standard IP54;

Coupler: moderate size, streamline design, [safe and comfortable](#) using;

Connector: [SINBON self innovated design](#), greatly reduces the coupling force;

Contact terminal: silver plated copper alloy, effectively [reduces contact resistance and prevent temperature rise](#) ;

Handle: [easy for lifting & lowering](#);

Cable: material [TPE](#) , with [excellent flexibility](#), soft touch, weathering resistance, fatigue resistance and temperature resistance.

